

Pressure Switch Electronic

for relative pressure 0 ... 145 psi (0...10 bar)



- Pressure switch and gauge
- Smart intelligent Sensor
- Light weight and space saving Design
- Two Output Signals programmable (no/nc)
- Hysteresis or Comparator Mode Operation
- Programmable Pressure Units (psi, bar, Mpa, kgf/cm²)
- LED Switching Status Indication
- Very Fast Switching – less than 2,5 ms
- Advanced Functions:
 - Programmable delays to 180 seconds
 - Access code prevents tampering

GENERAL DATA

Pressure Range	0 ... 145 psi (0 to 10 bar), relative to ambient pressure
Fluid	Filtered compressed air, lubricated or unlubricated, neutral gases
Pressure Units programmable	psi, bar, MPa, special units on request
Operating Voltage	10,8 VDC - 30 VDC ± 10 % (Short-circuit protected)
Digital Output	2 x PNP sourcing type transistor, 125 mA per output
Switching Frequency	Set-/ Reset Points programmable 0 – 100% FS 200 Hz

MECHANICAL DATA

Weight	45 g
Electrical Connection	M8 x 1 - 4 pin
Material Housing	Plastic ABS-PC / brass nickel-plated
Port	G 1/8" female (BSPP), ABS-PC / G 1/8" male, brass nickel-plated

ORDERING INFORMATION

Name	Sensor nano PSPDD pressure
Part Number	250 01 730 (G 1/8" female) 250 01 731 (G 1/8" male)



ELECTRICAL DATA

Operating Voltage	10,8 VDC - 30 VDC ± 10 % (Short-circuit protected)
Current Consumption	35 mA
Display Panel / Keypad	Bright 3-digit LED Display, LED-status indicator for each output, Keypad access protection prevents tampering
Repeat accuracy	0.2% of measured value
Ambient Temperature Influence	3% of measured value at 0 to 50°C
Test voltage	1000 VDC 1 min
Insulation resistance	>100 M at 500 VDC
Protection class	SELV

ENVIRONMENTAL

Mounting	Arbitrary
Max. Excess Pressure	16 bar
Degree of Protection	IP 65
Material Housing / Port	Plastic ABS-PC
Electromagnetic Compatibility	Adheres to DIN EN 50081-1 / DIN EN 50082-2
Shock Resistance	10G XYZ
Vibration Resistance	10 to 55 Hz, 1.5 mm, XYZ 2 hours

WIRING

PIN	WIRING	CABLE	PLUG
1	Ub+	brown	
2	OUT 2	white	
3	0V	blue	
4	OUT 1	black	

DRAWING

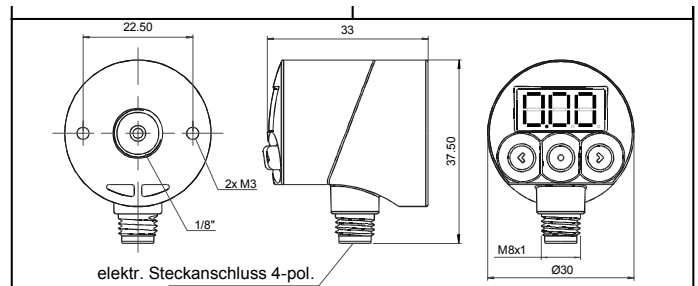

ACCESSORY

Cable with plug	5 meter with axial plug M8 x 1	110 26 310
Cable with plug	5 meter with radial plug M8 x 1	110 26 300
Mounting accessory	Installation Kit for Front Panel	080 40 570
Mounting accessory	Fixing Bracket	080 40 530

Installation Kit

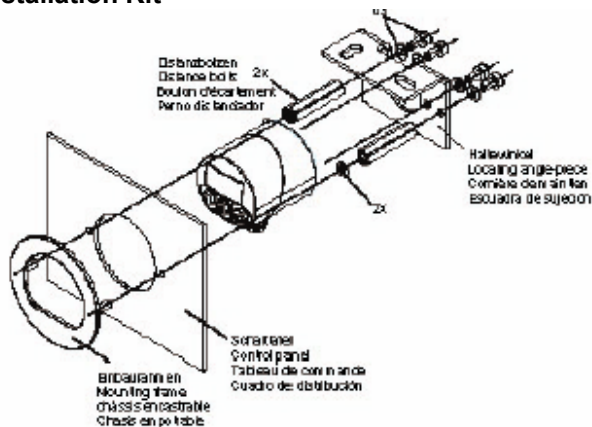

Cable M8 x1

